

# Bank Top Masterplan

Communities and Local Services Scrutiny

9<sup>th</sup> December 2021



**DARLINGTON**  
Borough Council

# Project Objectives



- Transform Darlington Train Station into a modern transport hub
- More frequent and faster local and national services and futureproof the station for future services
- Support and enhance the wider Darlington Regeneration initiatives



**DARLINGTON**  
Borough Council

# Component Parts of Project

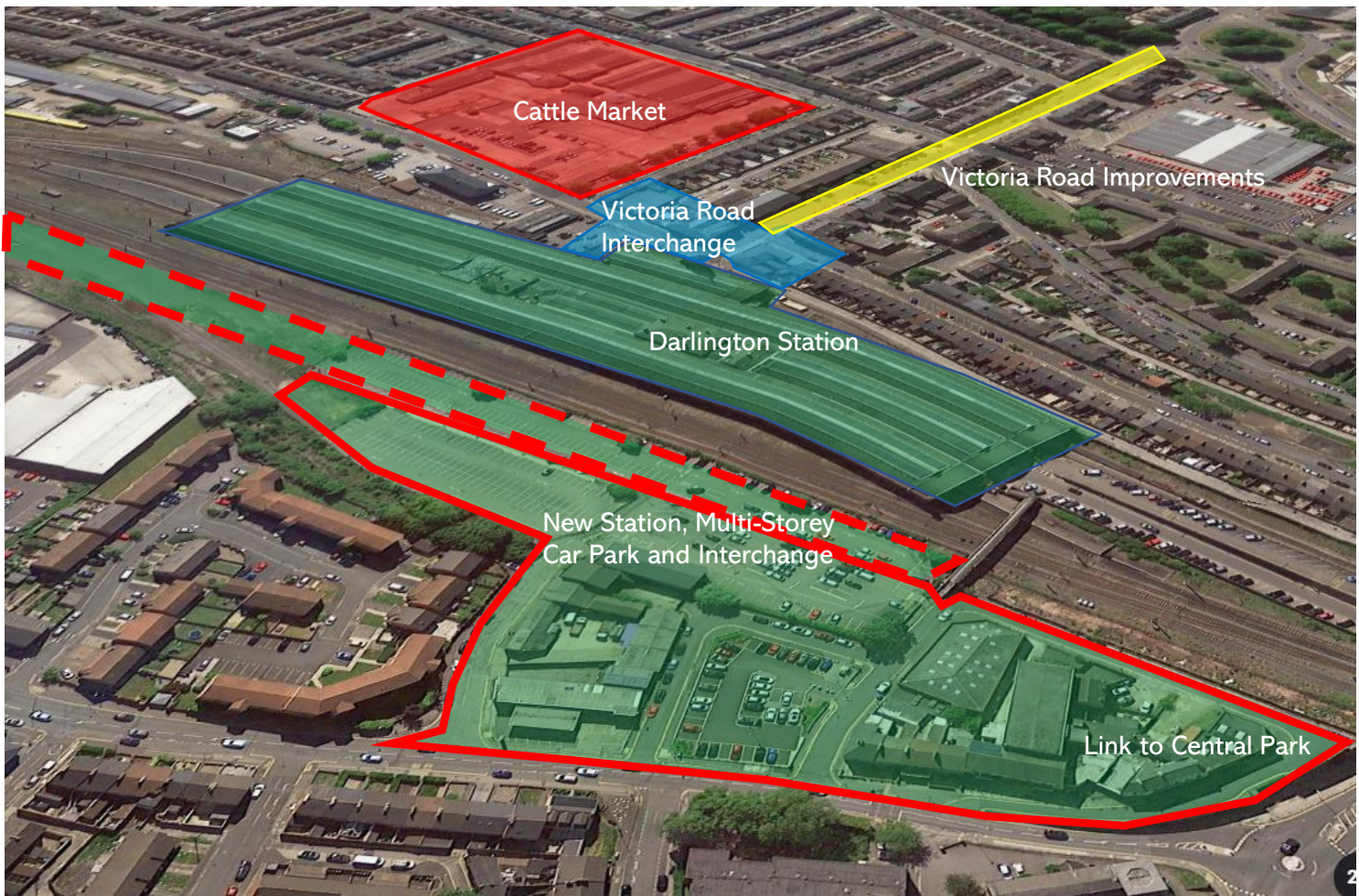

# Station East



## Key features

- New Station building
- New Local Platforms for Tees Valley Services
- Provision for new National London bound high speed platform
- New Bridge from new station to existing station
- New Multi-Storey Car Park
- New Transport Interchange including pick-up and drop-off.
- Pedestrian Bridge to Central Park - **Delivered**



# Station East

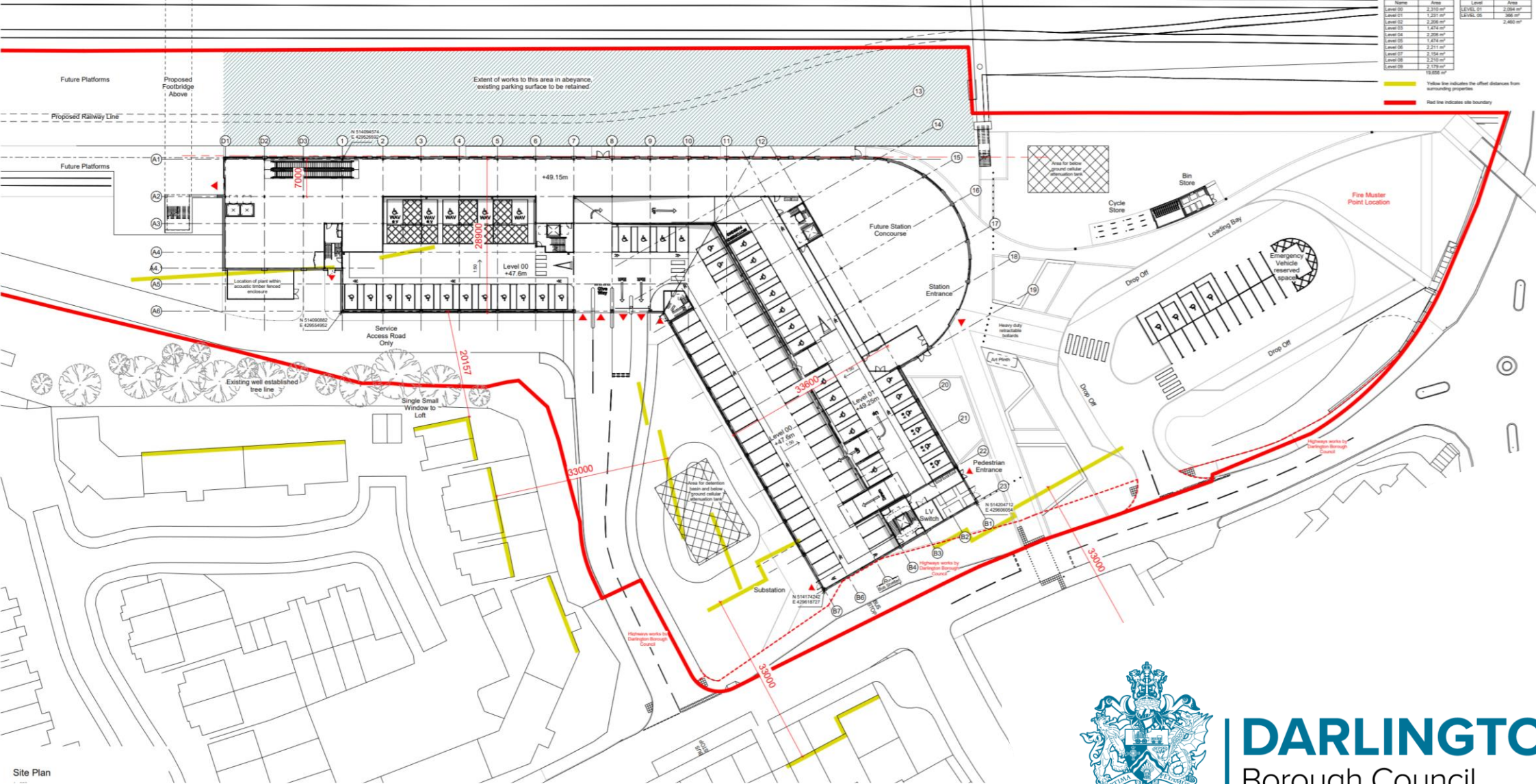

Site Plan



# Darlington Station



## Key features

- Portico Improvements
- Access for all enhancements
- Customer experience Enhancements
- Improvements to subway from improved portico.
- Rationalisation of Parking and access. (including ramp)
- Bridge to station east from within the station



# Transport Interchange – Victoria Road



## Key features

- Improved pedestrian space within portico and outside portico
- New pick-up and drop off
- New bus stop facilities
- Improved public realm to link to Victoria Road Scheme and town centre
- Improved link to Cattle Market Site



# Transport Interchange – Victoria Road

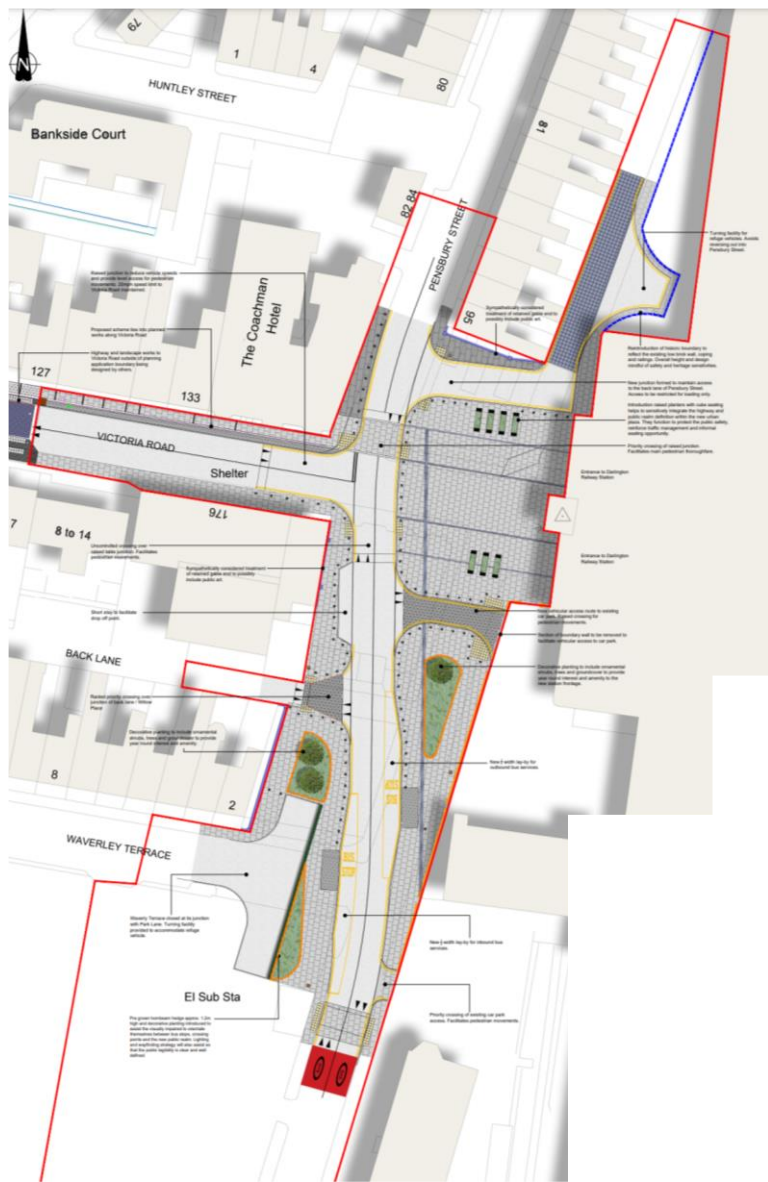



# Delivery

---



**DARLINGTON**  
Borough Council



## Station Gateway

Design & Build Contract – SCAPE Framework

|                       |              |
|-----------------------|--------------|
| Start CPO             | January 2021 |
| Planning Permissions  | Autumn 2021  |
| Enabling Works        | Spring 2022  |
| Start Construction    | Autumn 2022  |
| Complete Construction | Summer 2024  |

## Operational Rail & Station Enhancements

Network Rail & BAM Nuthall

|                                 |             |
|---------------------------------|-------------|
| Decision to deliver             | June 2022   |
| Complete Design                 | Summer 2022 |
| Complete Construction           | Summer 2024 |
| New track & station operational | Dec 2024    |

**Integrated Project Management Team & Governance**  
**Shared Planning Opportunities & Constraints**



**DARLINGTON**  
Borough Council

# Links to wider Regeneration Strategies

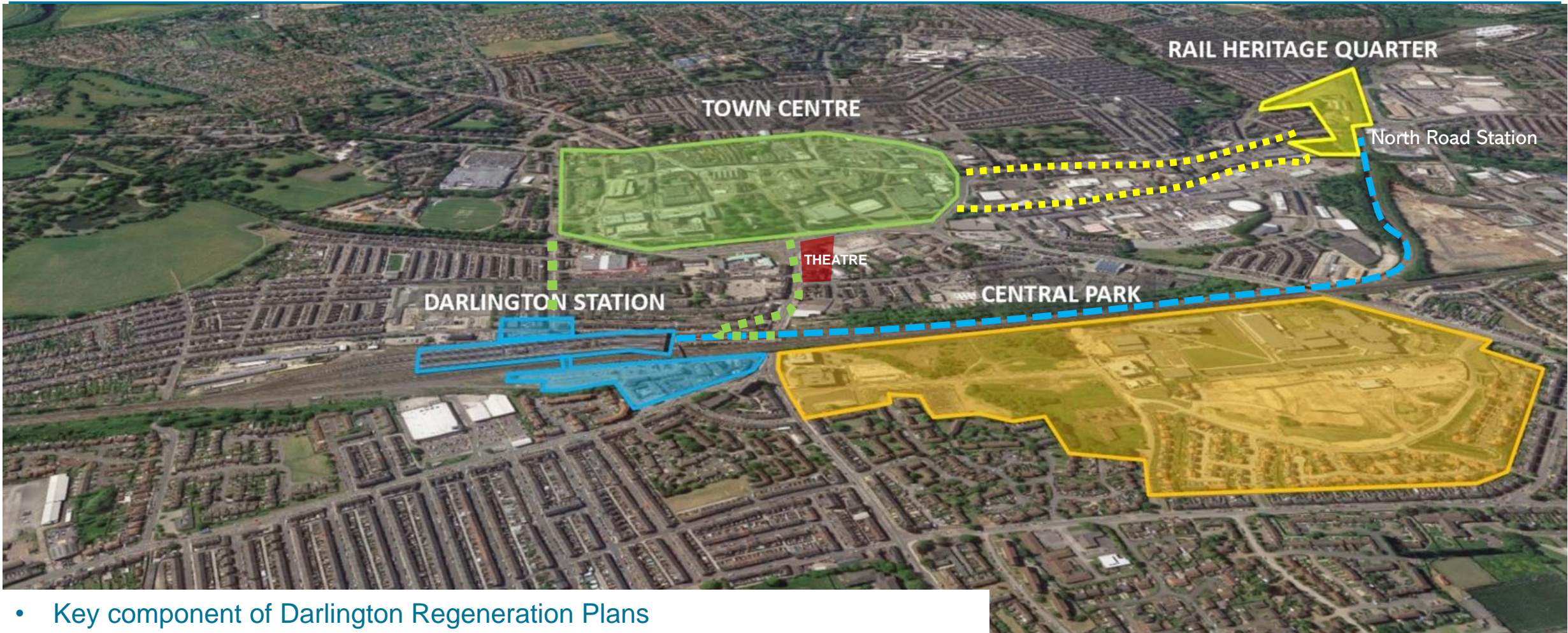

- Key component of Darlington Regeneration Plans
- Tees Valley's only ECML station – a passenger experience representative of the economic ambitions of the Borough and the wider Tees Valley Region



**DARLINGTON**  
Borough Council

# Concept



**DARLINGTON**  
Borough Council

# Concept



View looking southwest (from Neasham Road) - from the interchange towards the new station and multi-storey car park



**DARLINGTON**  
Borough Council

# Concept



View looking southwest towards the new station entrance



**DARLINGTON**  
Borough Council

# Concept



View looking north-west from Neasham Road - showing the multi-storey car park in the foreground and interchange beyond



# Concept



View east from Victoria Road to the portico entrance



# Latest Position

---

- Planning Approval for Eastern Gateway was granted 30<sup>th</sup> September 2021
- Planning Approval for Western Gateway was granted on 22<sup>nd</sup> October 2021
- Statement of Case supporting the making of the CPO has been submitted to the Planning Inspectorate
- Objectors have been notified
- Work continues to acquire property by agreement
- Provisional date for Public Inquiry is 18<sup>th</sup> January 2022

